

# Catalogue

TIMBER SYSTEMS



WINDOWS

DOORS

SLIDING SYSTEMS



# TIMBER JOINERY



What distinguishes wooden windows and doors is surely their elegance, nobility and naturalness. Window frames and doors made of wood can provide an unusual decoration both inside the house and in the facade. Undoubtedly, not only the appearance determines the quality of wooden joinery – its physical and functional properties are equally important. Windows and doors made of wood are excellent in terms of thermal and sound insulation, guaranteeing comfortable use of internal spaces. In terms of thermal insulation, they are in no way inferior to models made of materials such as PVC or aluminium. In the process of production, glue-laminated timber is used with an alternating system of wood grains so that it is protected against deformations during changes in temperature and humidity.

In particular, wood is carefully selected, regardless of what kind of tree it comes from. The wood joinery uses the available wood species, i.e. pine, meranti, oak, Siberian larch and spruce. The raw material is PEFC certified (Programme for the Endorsement of Forest Certification Schemes) – a non-governmental organisation for environmental protection. The PEFC system is used worldwide and promotes forest management in an environmentally friendly manner.







One of the most valued species of wood. It has an exceptionally distinctive design of grains, which undoubtedly gives it the originality. Meranti windows are durable, highly resistant to water and extreme temperatures. In addition, they have excellent thermal and acoustic qualities.

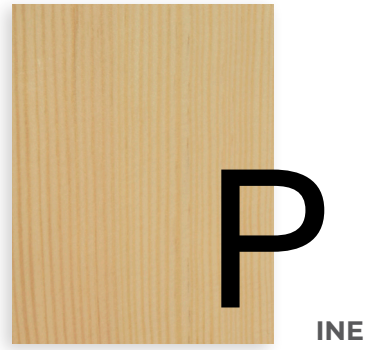

It is characterised by a bright, warm colour which is perfectly suited to the rustic interior arrangement and more austere design. It has been used in the production of timber joinery for years due to its ease of processing and durability. It provides excellent acoustic and thermal insulation as well as high resistance to weather conditions.



Perceived as one of the best materials for the production of wooden joinery elements. It impresses with its strength, weight and durability. An additional advantage is the longevity of oak and its resistance to abrasion. It provides exceptional thermal and acoustic protection. The original wood grain pattern is undoubtedly an additional advantage of oak.



Larch wood is a hard and quite heavy material with extraordinary durability. It has high resistance to adverse weather conditions. This wood has very good physical and mechanical characteristics. Its elegant appearance will be perfect for interiors in a modern or classic style.



This type of wood is primarily characterized by lightness and flexibility, and at the same time strength and durability. Spruce wood is highly resistant to moisture and biological corrosion. It is ideally suited for use in wood -aluminum joinery. Spruce, thanks to its properties, enjoys great recognition.



# MANUFACTURING PROCESS



Supply of the best quality square timber from certified sources.



Cutting and milling on a machining center.



Adhesive bonding with a high-level glue.

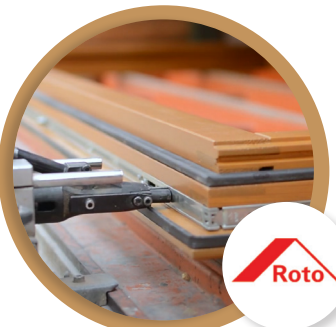

Installing construction hardware.



Coating in accordance with the patented technology.



Grinding and quality control of square timber.



Glazing.



Quality control of made constructions.



The process of packing the construction and preparing for transport.







# WINDOW DJ 68

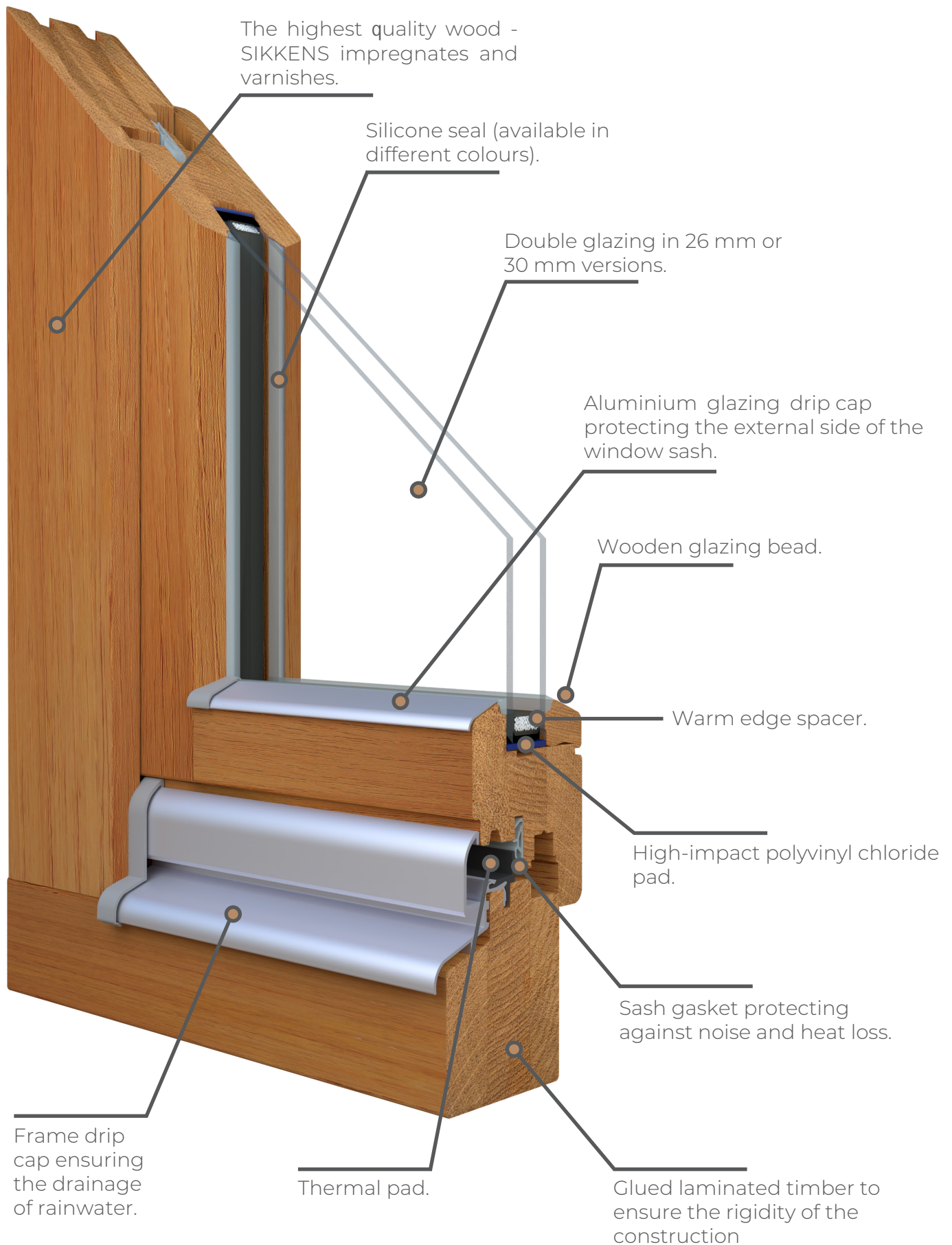



# DOOR DJ 68

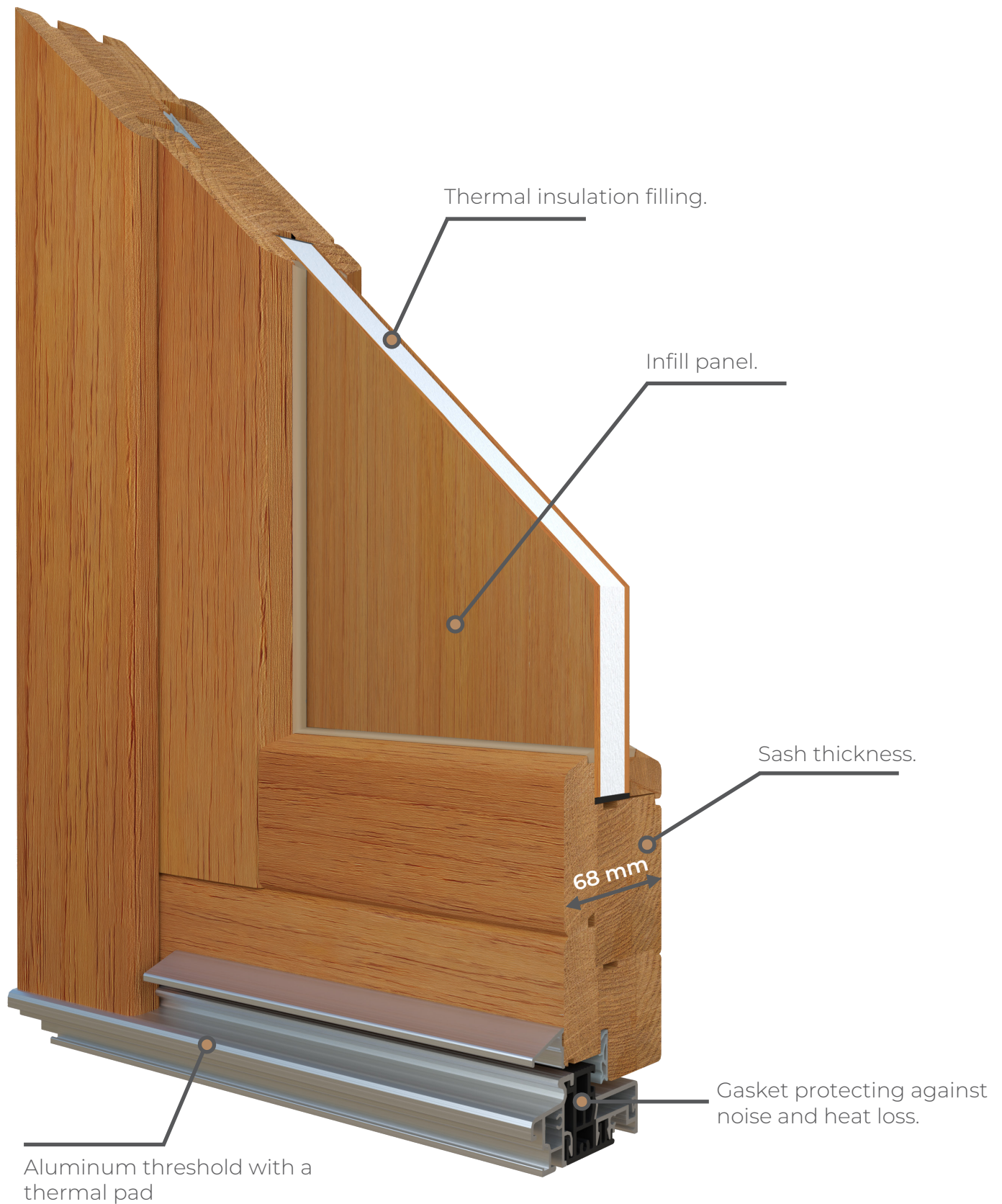

# WINDOWS

## DJ 68



### WINDOW

U<sub>w</sub>  
from **1,1**  
W/(m<sup>2</sup>K)\*

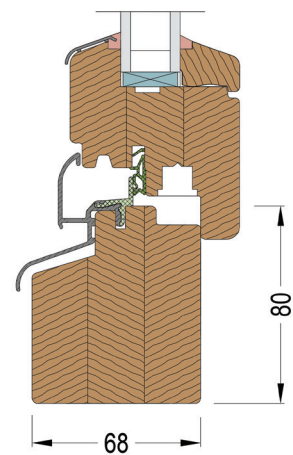
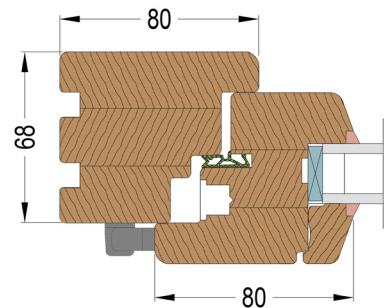

## DJ 78



### WINDOW

U<sub>w</sub>  
from **0,89**  
W/(m<sup>2</sup>K)\*

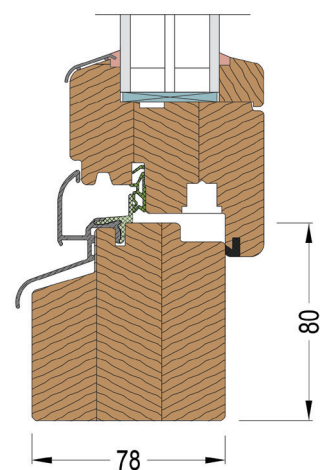
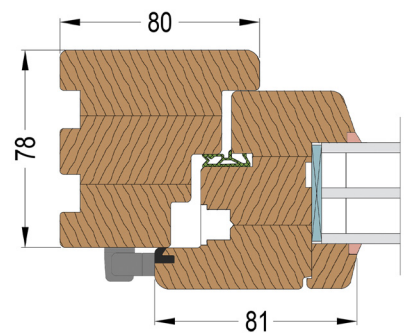



The windows in DJ 68 and DJ 78 systems are made of three-layer laminated timber which prevents warping or deformation of the construction.

In addition, the frames are protected against external factors by applying paint coatings based on water-soluble varnishes.

**Window profile thickness:** 68 mm, 78 mm

**Available wood species:**

- solid pine/finger-jointed pine
- solid meranti/finger-jointed meranti
- oak,
- larch,
- spruce

Available glazing packages:

- DJ 68: single-chamber double-glazed units 26 mm and 30 mm
- DJ 78: double-chamber triple-glazed units 36 mm and 40 mm
- a wide selection of safe, acoustic, ornamental and anti-burglary glass

Drip caps:

- aluminium ALURON with a thermal insert, in various variants - rounded, angular, covered with wood
- wooden - semicircular on the frame and wooden sash cover



French profile window

DJ68, DJ78 systems enable the production of windows in a wide range of non-standard shapes: circles, slants, trapezoids, arches and false arches in a wide selection of RAL and NCS colors by SIKKENS

Bicolor windows - the profiles can be painted in two different colors - one in the interior of the room and another on the facade.

Fittings and handles:

- ROTO circumferential fittings, microventilation in the basic version and anti-burglary

Glazing bars:

- glued-on 26 mm, 34 mm and custom-made glazing bars
- internal - wide range of widths and colors
- structural 56 mm

Gasket:

- Schlegel Q-Lon available in various colors

Accessories:

- low aluminum threshold for balcony door
- balcony handles
- decorative panels
- aluminium external windowsills
- internal windowsills
- additional gasket for DJ 68
- ventilators
- glazing bars
- opening limiters
- key lockable handle
- double-sided handle
- masking strip
- top mounted roller shutters



# EXEMPLARY WINDOW SHAPES

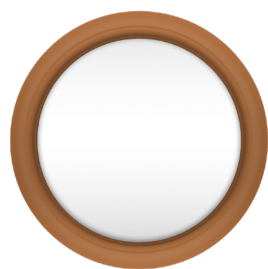

Circle



Arch

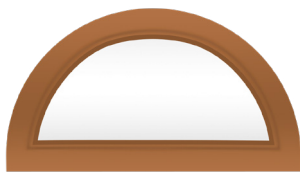

Semicircular arch

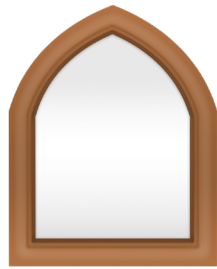

Gothic arch



Irregular arch



Screen with variable angle coupler



Trapezoid

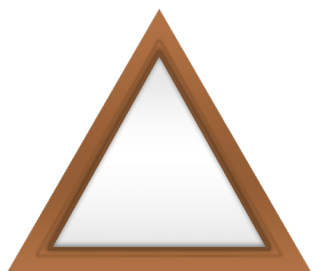

Triangle



Screen

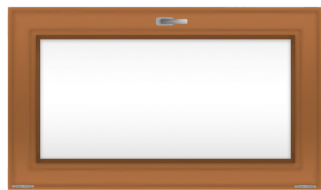

Tilt-only window



Arched window with a floating mullion



Window with arch and transom bar





# RETRO



Historic effect plus modern technology. This unique window allows you to reproduce the wood joinery from the past. It is ideal for objects that are under the control of monument conservators. Available in 68 mm and 78 mm profiles. The window can be styled to any shape (trapezoid, slant, triangle) and dimensions.

What characterizes RETRO windows is above all:

- rich equipment - decorative strips, handles, covers
- decorative glazing beads
- decorative sash milling from the outside
- decorative cover strips, heads, ornaments
- decorative masking strips
- decorative transom bars
- glazing bars

Heads and decoratively milled strips

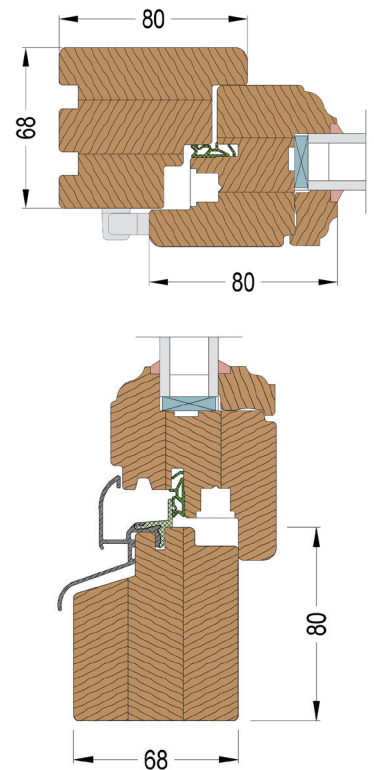

Retro wooden windows are perfect for historic buildings or objects styled to look like from past years, they combine a unique and elegant look with modern technologies.

# ALUMINIUM CLADDINGS

## Gemini Classic



**WINDOW**  
Uw  
from **0.74**  
W/(m²K)\*

System which has classical shape of aluminium claddings. It is the most popular of Gemini wooden-aluminium systems. It is available in the largest number of construction variants among all offered Gemini systems. System profiles can be offered as frames with crimped or welded corners. Its features and performance parameters allow for versatile and universal use. It is highly functional and aesthetic. There is a possibility to make this system in shape of an arch and a circle as a fixed window, while maintaining the appropriate dimensions.

Claddings are intended for:

- window systems
- door systems
- sliding systems - HST

Thickness of timber section: 68/78/88 mm

## Gemini Soft Line



**WINDOW**  
Uw  
from **0.74**  
W/(m²K)\*

Gemini Soft Line is distinguished by the rounded shape of aluminum profiles. The system has high operational parameters in terms of mechanical, insulation and acoustic properties. System profiles can be ordered as frames with crimped or welded corners. Its features and parameters allow for comprehensive and universal use of the product wherever the rounded line of system profiles fits in with the architectural concept of the building. There is a possibility to make this system in shape of an arch and a circle as a fixed window, while maintaining the appropriate dimensions

Claddings are intended for :

- window systems
- door systems
- sliding systems - HST

Thickness of timber section: 68/78/88mm











## Gemini Quadrat



**WINDOW**  
U<sub>w</sub>  
from **0.76**  
W/(m<sup>2</sup>K)\*

Gemini Quadrat is a system with clearly outlined profile edges. The surface of the sash is shifted in relation to the surface of the frame, creating two distinct planes. It is distinguished by an extremely minimalist and geometric design, particularly important in modern buildings. Its uniqueness is emphasized by the fact that the aluminum profiles of the Quadrat system do not have a marked slant and they form a right angle with the outer surface of the profile. There is a possibility to make this system in shape of an arch and a circle as a fixed window, while maintaining the appropriate dimensions

Claddings are intended for :

- window systems
- door systems
- sliding systems - HST

Thickness of timber section: 68/78/88mm

## Gemini Quadrat FB



**WINDOW**  
U<sub>w</sub>  
from **0.76**  
W/(m<sup>2</sup>K)\*

This system has clearly outlined profile edges. In the FB variant the sash surface is flushed with the frame surface, visually creating one plane. The special shape of the aluminum leaf, which extends the glass by 15 mm to compared to conventional solutions, enables the use of a wider glazing unit with a smaller cross-section of wood. Aluminium profiles of the Quadrat FB system do not have slant marked. There is a possibility to make this system in shape of an arch and a circle as a fixed window, while maintaining the appropriate dimensions

Claddings are intended for:

- window systems
- door systems
- sliding systems - HST

Thickness of timber section: 68/78/88mm

\* Heat transfer coefficient for a reference for window of size 1.23m x 1.48m and U<sub>g</sub> = 0.5 W/(m<sup>2</sup>K)



## Gemini Retro

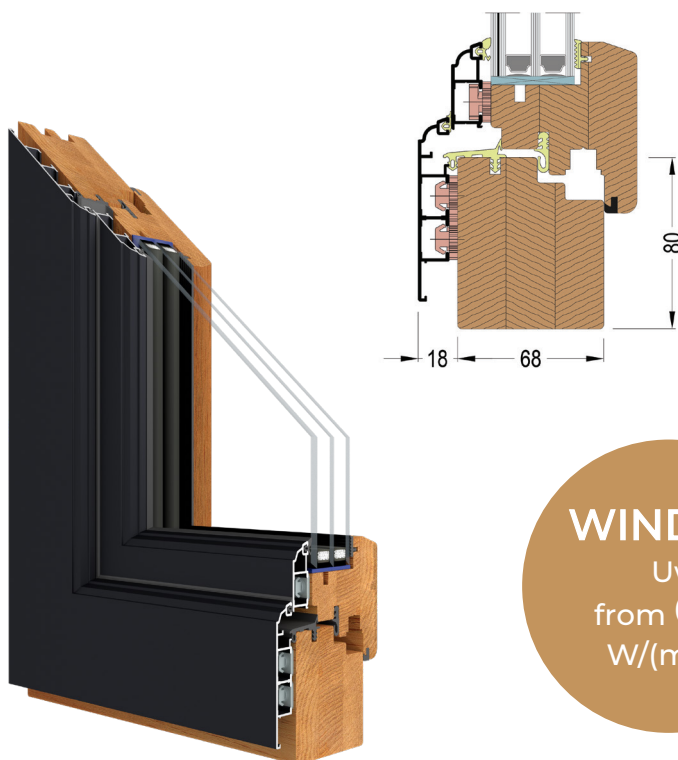

### WINDOW

$U_w$   
from **0.74**  
 $W/(m^2K)^*$

Gemini Retro is a system designed for historic or historic-style buildings. The specially profiled shape of the aluminum claddings gives the windows an elegant, classic and timeless character.. Wide range of colors allow matching windows made in this system to the most sophisticated applications. The Retro system stands out in the Gemini product group both in terms of design and functionality, offering a wide range of available constructions and very good performance parameters. There is a possibility to make this system in shape of an arch and a circle as fixed window, while maintaining the appropriate dimensions.

Claddings are intended for :

- window systems
- door systems
- sliding systems - HST

Thickness of timber section: 68/78/88 mm

## Gemini Passiv



### WINDOW

$U_w$   
from **0.65**  
 $W/(m^2K)^*$

Gemini Passiv is a system for wooden-aluminium windows. It has excellent thermal and acoustic insulation, high tightness, air permeability and resistance to wind load. . This system uses innovatory insulating material of high strength made of foamy polysterene. Additional elements distinguishing this system from traditional wooden-aluminium constructions are: wider main gasket, PE cord, additional middle gasket and the use of Chromatech Ultra or Premium Edge (Multitech)warm edge spacer.

Claddings are intended for :

- window systems

Thickness of timber section: 68 mm



## Gemini Linear

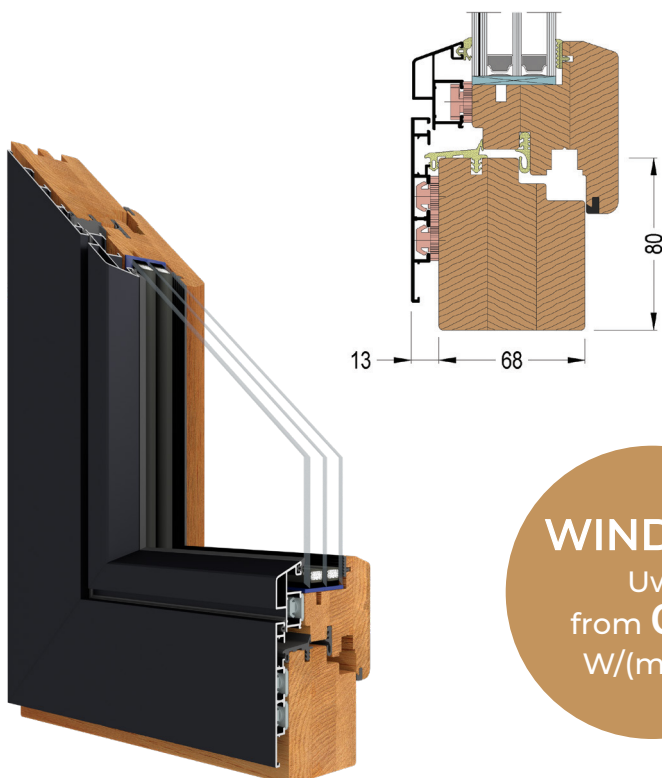

Gemini Linear is a system in which the sash surface is flushed with the frame surface - it creates a clear angle with the external plane of the profile. It has above average functionality and high performance parameters. It finds its usage everywhere where flushed and modern visual form goes great with architectural design and building concept. System profiles can be ordered as frames with crimped or welded corners. There is a possibility to make this system in shape of an arch and a circle as fixed window, while maintaining the appropriate dimensions.

**WINDOW**  
 $U_w$   
 from **0.76**  
 $W/(m^2K)^*$

Claddings are intended for :

- window systems
- sliding systems - HST

Thickness of timber section: 68/78/88mm

\* Heat transfer coefficient for a reference window of size 1,23m x 1,48m and  $U_g = 0,5 W/(m^2K)$



# SLIDING AND BI-FOLDS SYSTEMS

## Patio Fold



The use of the Patio Fold folding door system is a great way to get more light into the room. After folding the sashes, the entire glazing disappears, and thanks to this, you can easily and quickly obtain a passage with a width adapted to your needs. The whole construction has also very good thermal parameters. All those features make this system willingly used as an exit to the winter garden, to the terrace, or as walls dividing rooms.

Available in two options:

- in wood only (68 mm profile)
- in version with aluminium cladding (68 mm profile)

Patio Fold sash opening schemes

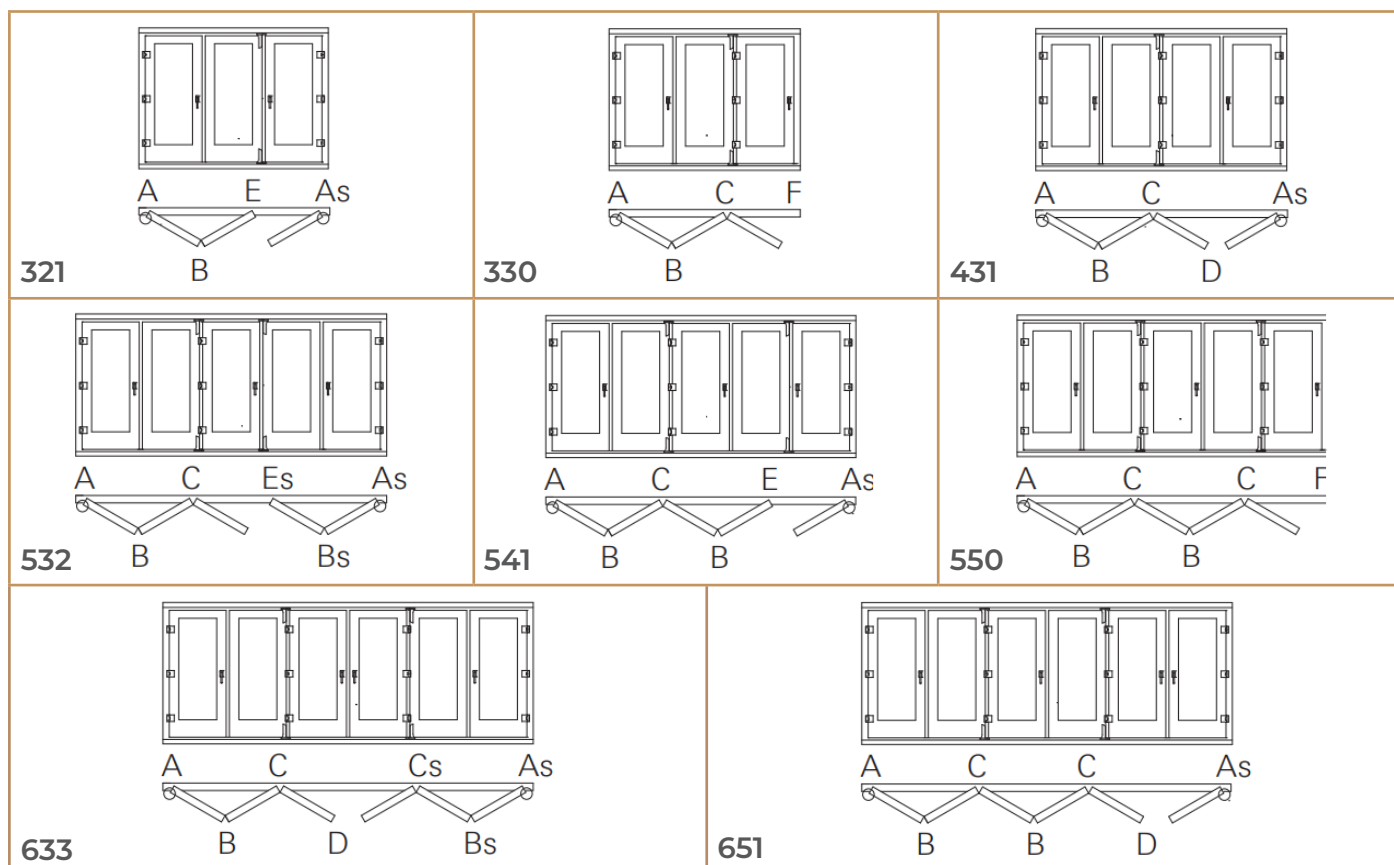

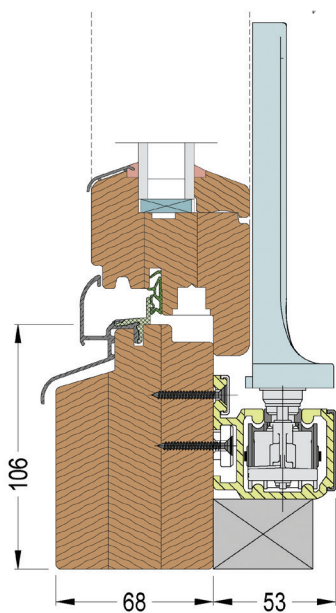

Bi-folding  
door Patio  
Fold 68

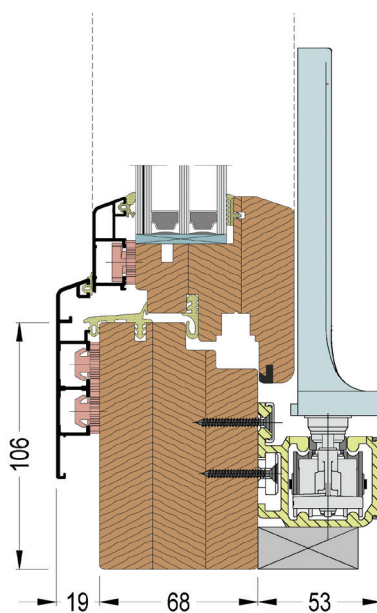

Bi-folding door  
Patio Fold 68 + Classic aluminium  
cladding



Bi-folding door  
Patio Fold 68 + Classic aluminium  
cladding



# HST



Lift & Slide door is an ideal composition of aesthetics, comfort and modernity. HST system is a great solution for a comfortable entry to a balcony, a terrace or a garden. When the sash is open, it does not take space inside the room and large glazing let in more sunlight. The HST system is equipped with a new generation of GU fittings, which are characterized by exceptional lightness and quiet operation.

Additional options:

- SILENT CLOSE shock absorbers
- possibility of electronic control
- threshold system supports
- possibility of using various handles: from shapes to configurations - handle-handle, handle/flush pull handle

Available in two variants:

- in wood only (78 mm profile)
- in version with aluminium cladding (68/78/88mm profile)

HST opening schemes

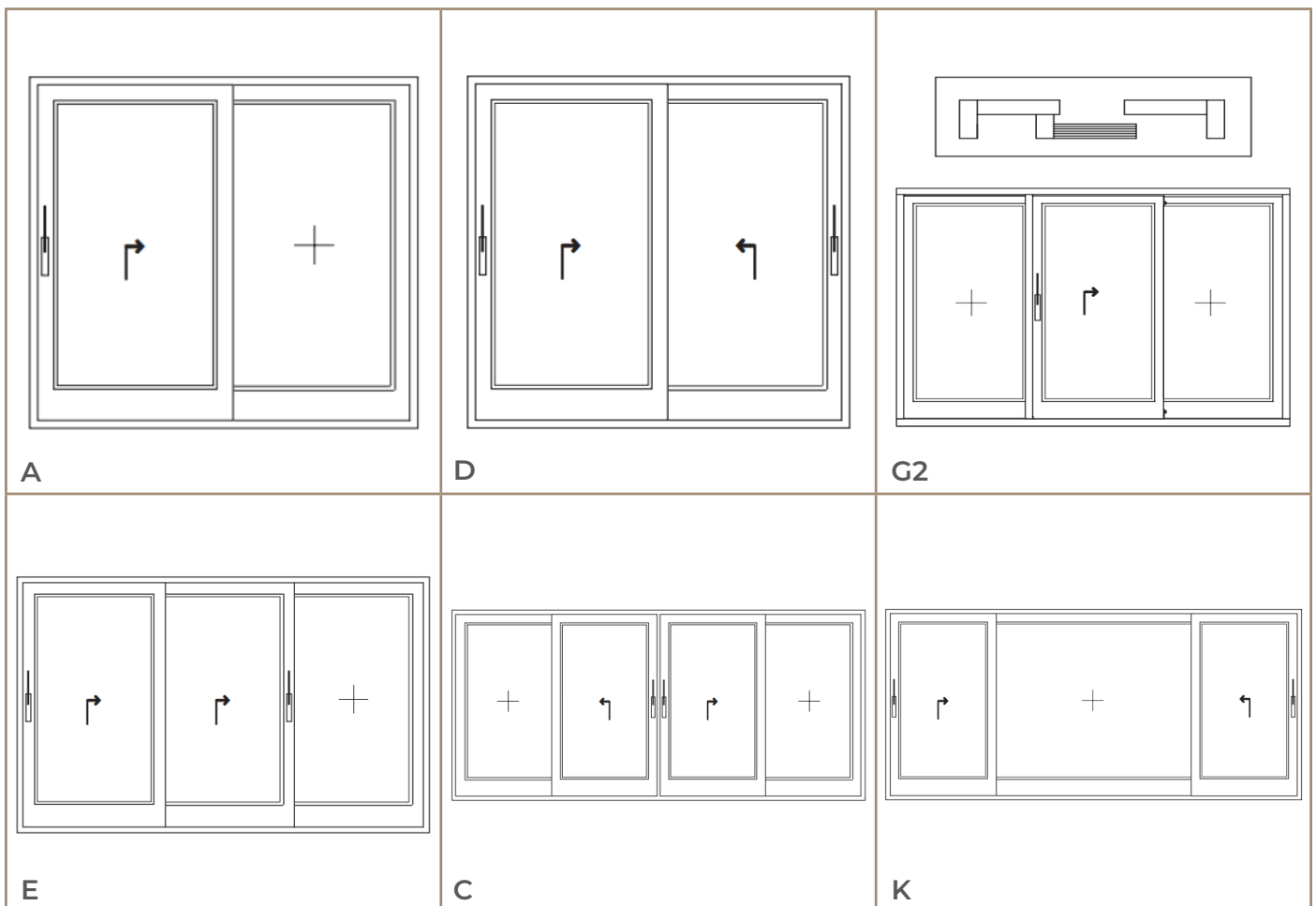



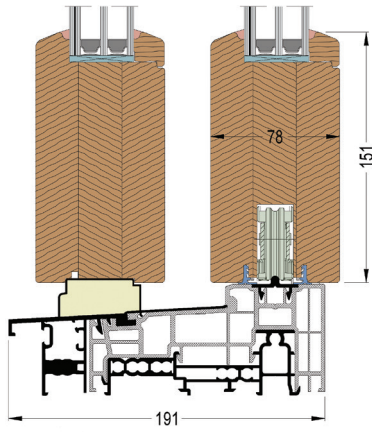

Lift & Slide door  
HST 78

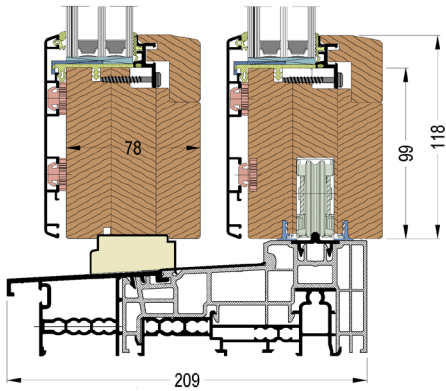

Lift & slide door  
HST 78 + Classic aluminium  
cladding

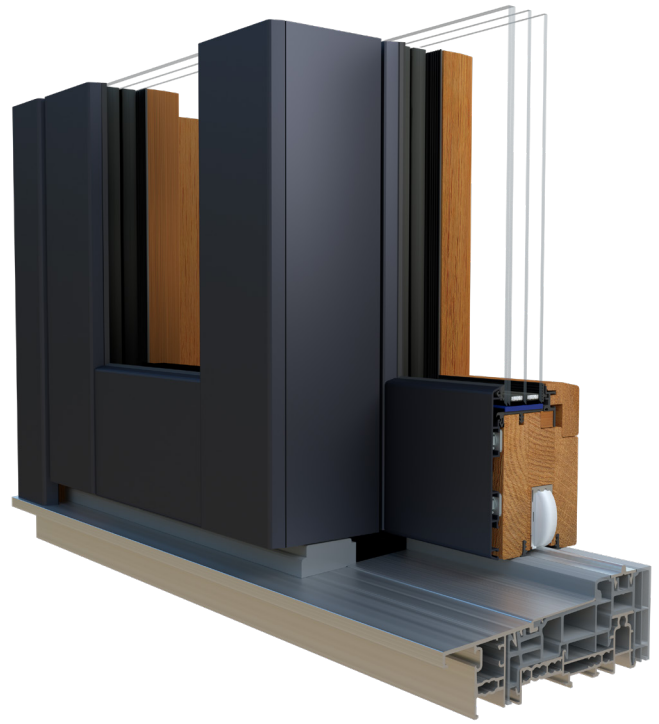

Lift & slide door  
HST 78 + Classic aluminium  
cladding



# PSK



The tilt and slide door is a combination of a tilt window and a sliding door. Undoubtedly, the main advantages of PSK system are functionality and user-friendliness. An additional advantage is the sash tilt function, which allows free ventilation of the room, and at the same time a high safety level. The PSK tilt and slide door is a great alternative to the HST lift and slide door. A parallel mechanism slides the sashes on almost noiseless rail and in that case it does not open to the inside of the room. PSK door offers excellent thermal insulation and great material specification. It is mainly used at the entrances to the terrace garden and balcony.

Available in two variants:

- in wood only (68/78 profile)
- in version with aluminium clad (68/78/88 mm profile)

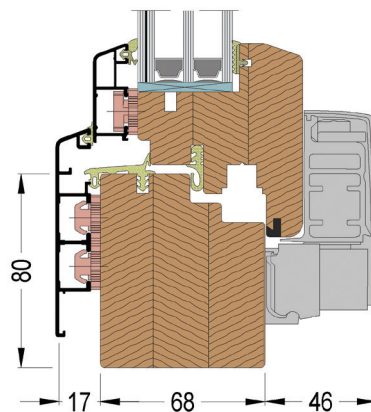
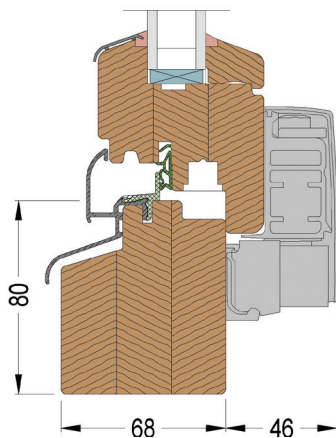
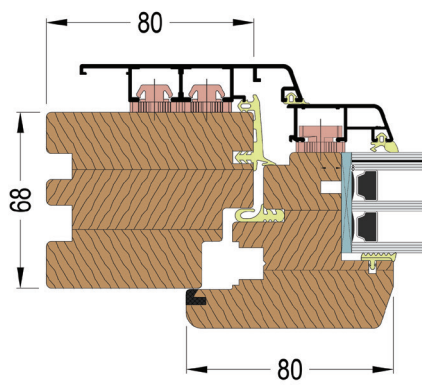
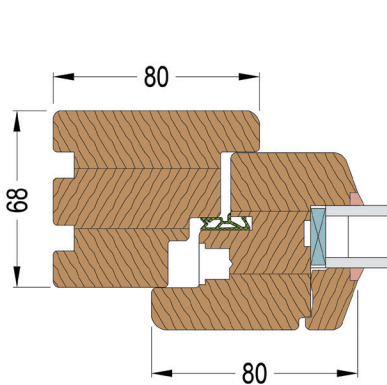

Tilt and slide door  
PSK 68

Tilt and slide door  
PSK 68 + Classic aluminium  
cladding

Tilt and slide door  
PSK 68 + Classic aluminium  
cladding







# Entry door

DJ 68/DJ 78



Wide  
range of  
colors

Wooden doors in DJ 68 and DJ 78 systems like windows are made of three layers of glue-laminated timber, which prevents warping and curving of the construction. Additionally thanks to the application of special paint coatings based on water-soluble varnishes, the wood is protected against harmful external factors.

**Thickness of door profile:** 68 mm, 78mm

**Available timber species:**

solid/finger-jointed pine, solid/finger-jointed meranti, oak, larch, spruce

**Available in two variants:**

- in wood only (68/78 mm profile)
- in version with aluminium cladding (68/78/88 mm profile)

**Standard equipment:**

- ALU threshold 32 mm + ALU lower sash cover (in set with threshold)
- 3-point lock
- euro cylinder + 3 keys
- SFS 3D hinges with adjustment in 3 planes (hinges in different colors)
- double-sided FKS handle
- infill panel
- for double-leaf doors - passive leaf opened on bolts
- smooth or decorative wooden panels
- in wooden-aluminium doors panel covered by 2mm sheet metal

**Additional options:**

- drop seal automatic threshold
- simple INOX pull handle in few variants
- other handle models
- multipoint locks, high class cylinders
- door closer
- electric strike
- sash cover (wooden kick plate)
- peephole
- letterboxes, letterbox slots
- additional wooden decorative sash parts
- electronic locks







Door DJ 68



Door DJ 68 with  
Classic aluminium  
cladding



Door DJ 68 with panel



Door DJ 68 with  
cladding profile

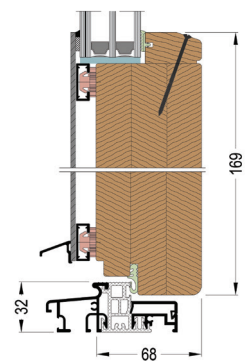
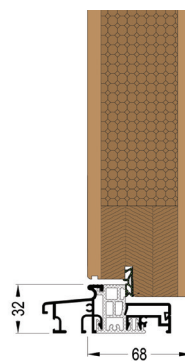
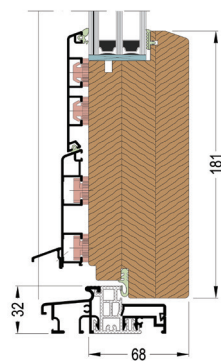
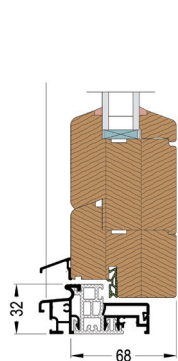
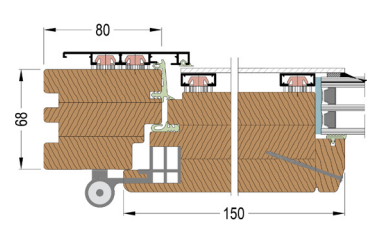
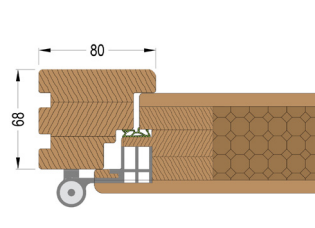
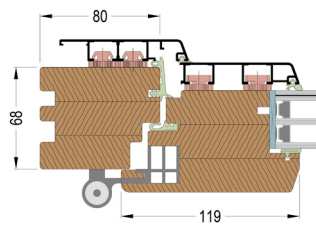
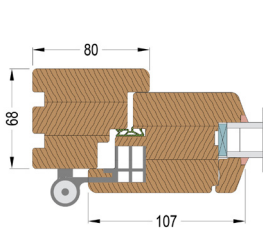

Door DJ 68

Door DJ 68 with Classic  
aluminium cladding

Door DJ 68 with panel

Door DJ 68 with  
cladding profile







# COLOURS CHART

For wooden systems we offer rich colour chart from Remmers - from azure to RAL and NCS coating.

## Standard REMMERS colours



## Additional complementary colours REMMERS

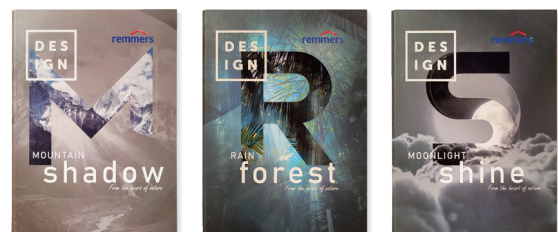

REMMERS INDULINE - handy colour patterns in book format

## RAL or NCS coating colours



For wooden-aluminium systems we offer ALURON colour chart: RAL MAT, RAL FS, METALLIC FS, DECOR MAT, ANODIZED & EFFECT COLORS

## ALURON colour patterns





