



WINDOWS, DOORS, SLIDING SYSTEMS  
**PVC systems**

**CATALOGUE**

# Table of contents

windows systems	4
Kömmerling 70 AD	6
Kömmerling 76 AD	8
Kömmerling 76 AD AluClip	10
Kömmerling 76 MD	12
Kömmerling 76 MD AluClip	13
Kömmerling 76 MD AluClip Zero	14
Kömmerling 88	16
Kömmerling 88 AluClip	17
 doors systems	 18
Kömmerling 76	20
Kömmerling 76 AluClip	20
Kömmerling 88	22
Kömmerling 88 AluClip	22
 Sliding systems	 26
PremiDoor 76	28
PremiDoor 76 AluClip	29
PremiDoor 76 Lux	29
PremiSlide 76	32
PremiSlide 76 AluClip	33
 Colours	 36
 Fittings	 38







# Window SYSTEMS





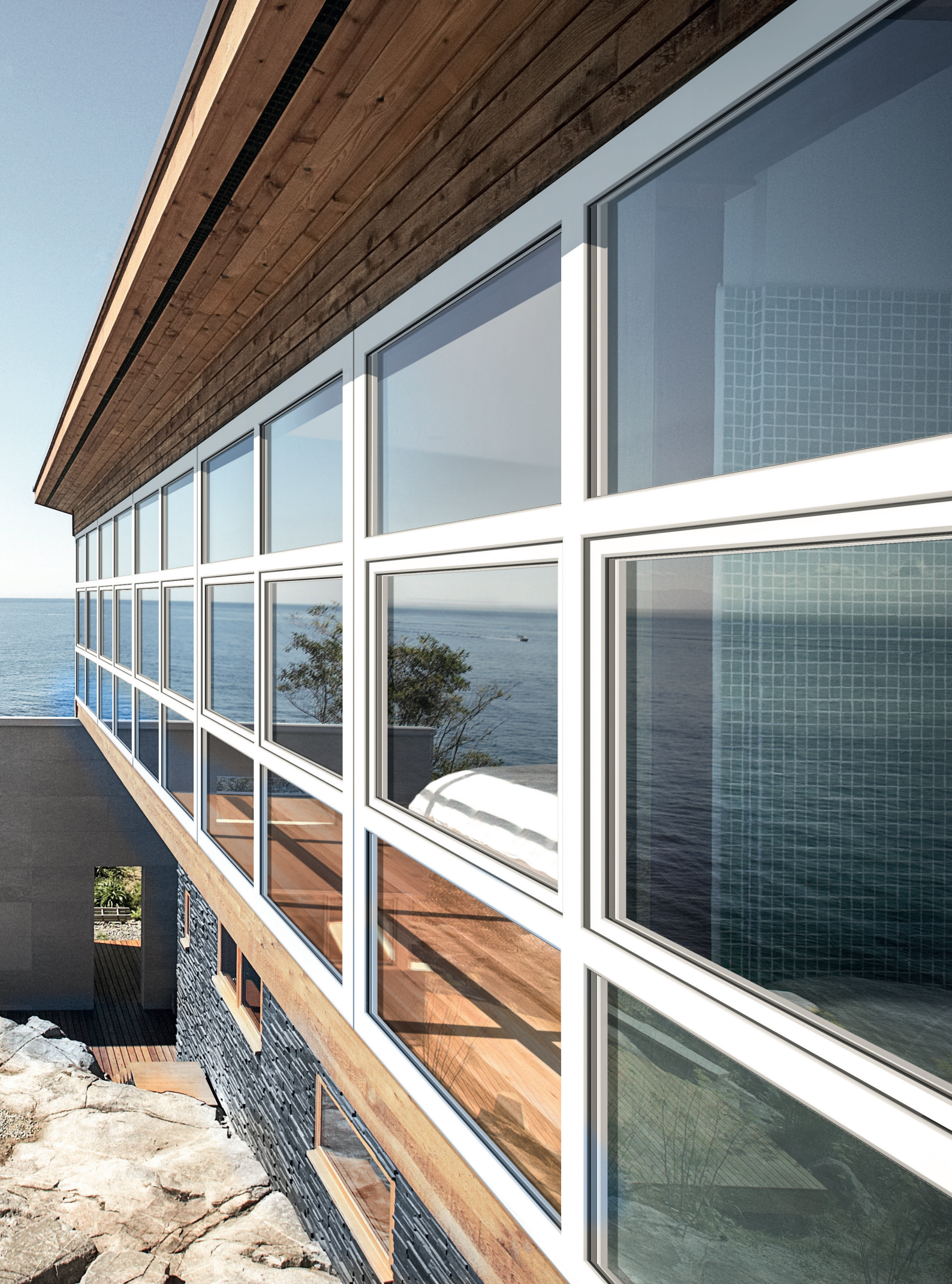



# Kömmerling 70 AD

## window system

### Something more than standard

All features reserved for exclusive window systems now available as standard in the new Kömmerling 70 system.

A modern window system with a frame depth of 70mm. The undeniable advantages of this system are: significant savings on heating costs, high acoustic insulation, optimal protection against burglary and a wide range of finishing the external surface of the profiles.

The most optimal installation depth. Maximum amount of light in the spaces thanks to the use of narrow profiles. Increased static parameters - the possibility of constructing high balcony doors and large windows. Special construction of the profile - double thermal protection. Elimination of thermal bridges inside the profiles. Possibility of mounting exceptionally warm glazing units.

Universal, timeless style of the window, ideally suited to modern buildings and renovations. Modern window design with a wide range of colors. Possibility to choose of wood-like and uniform colors from the RAL color palette.

Greenline lead-free zinc-calcium stabilizers.

**greenline** 



white color

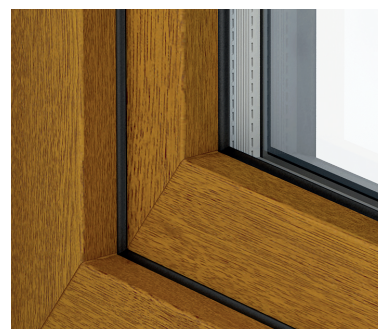

Colours and wood structure



Universal smooth, embossed colors

### System 70 AD

- Heat transfer coefficient  $U_w=0.89 \text{ W}/(\text{m}^2\text{K})$  with the triple glazing package up to 44 mm thick\*
- 5-chamber technology
- Meets WT 2021 requirements

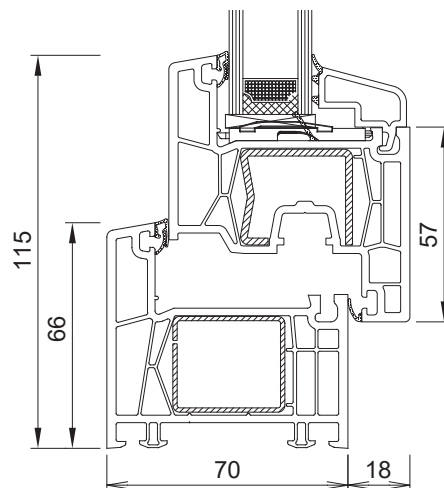

\* Heat transfer coefficient for the reference window (1230 x 1480,  $U_g=0.6 \text{ W}/(\text{m}^2\text{K})$  with warm Chromatech Ultra spacer)





Heat transfer coefficient  $U_w=0.89 \text{ w/(m}^2\text{K)}^*$



Acoustic insulation up to 47 dB



wind load resistance up to C5/B5  
Rainwater tightness up to 9A  
Air permeability up to class 4



Veneer in wood structure or universal colors



Anti-burglary protection



The systems are subject to various controls, they have the CE mark and declarations and certificates for all variants

Fixed mullion  
70320 - 70220

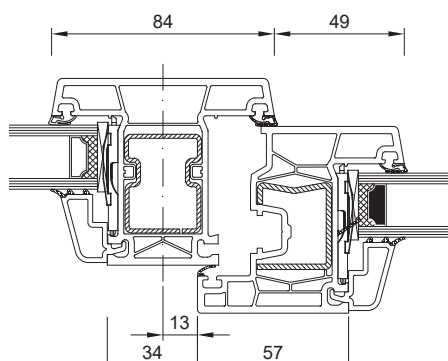

Flying mullion  
70420 - 70220

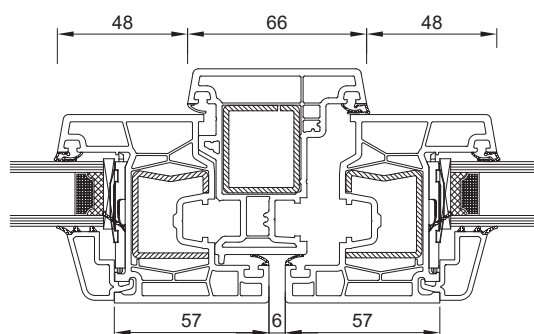

\* Heat transfer coefficient for the reference window (1230 x 1480,  $U_g=0.6 \text{ w/m}^2\text{K}$  with warm Chromatech Ultra spacer)

# Kömmerling 76 AD

## window system

It has all the parameters of a modern window of the future

A modern and best-in-class PVC window and door system. The highest quality, measurable savings on energy costs, optimal protection against noise, reliable protection against burglary and various possibilities of shaping the external surface prove the advantage of the system.

The innovative design of the Kömmerling 76 AD system allows the window to be fitted with modern triple-pane packages with a thickness of 16 mm to 48 mm and various functional panes. Thanks to intelligent fastening techniques, professional assembly is carried out quickly, efficiently and without much effort.

Kömmerling 76 AD is characterized by high energy savings - a new 76 mm system with a rebate gasket with the highest thermal insulation parameters -  $U_w$  value for the reference window up to  $1.1 \text{ W}/(\text{m}^2\text{K})$ .

All plastic profiles are made of a material with lead-free stabilizers based on calcium and zinc. The system is available in white and in decor veneer in a wide range of colors with a smooth, embossed or wooden structure. It is also possible to use innovative AluClip aluminum overlays to give the structure modern appearance of aluminum windows and improve their parameters.

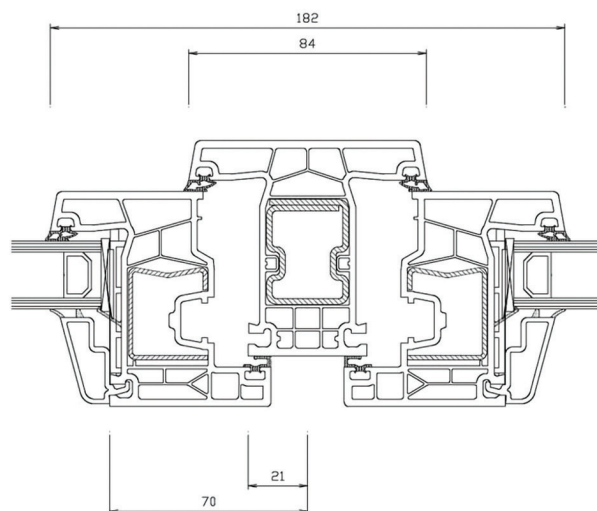
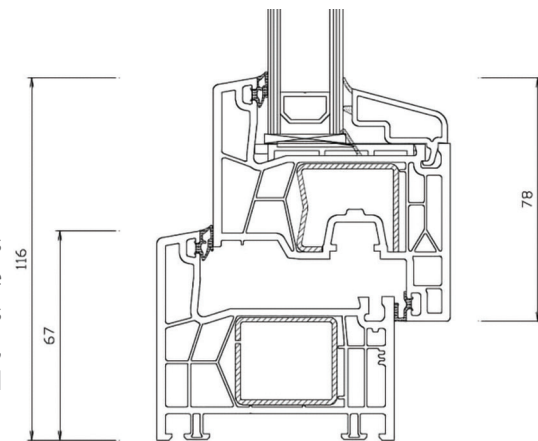

white color



Colors and wooden structure



Universal smooth or embossed colors

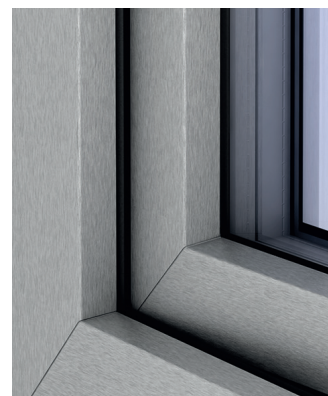

Metallic colors









Heat transfer coefficient  $U_w=1,1 \text{ w}/(\text{m}^2\text{K})^*$



Izolacja akustyczna do 47 dB



wind load resistance up to C5/B5  
Rainwater tightness up to 9A  
Air permeability up to class 4



Veneer in the structure of wood, universal colors or with a metallic appearance



Anti-burglary protection



The systems are subject to various controls, they have the CE mark and declarations and certificates for all variants

## Kömmerling 76 AD aluminum cladding

### Kömmerling 76 AD AluClip

- Higher thermal insulation compared to aluminum windows -  $U_f$  value =  $1.2 \text{ W}/(\text{m}^2\text{K})$
- $U_w = 1,0 \text{ W}/(\text{m}^2\text{K})^*$
- From the outside it looks like aluminum, inside natural warm white PVC
- Design depth 81.5 mm
- Almost unlimited color palette of aluminum elements
- A large spectrum of glazing up to 50 mm with triple glazing

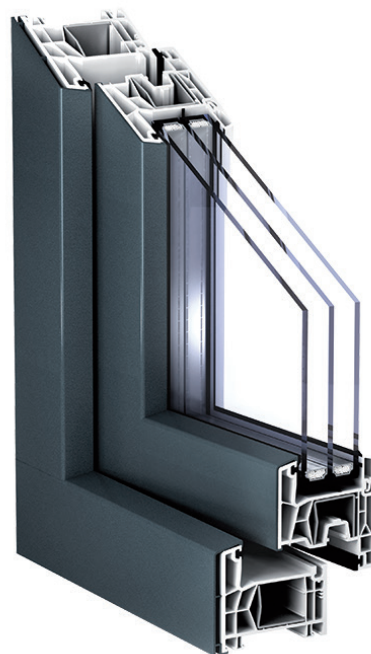
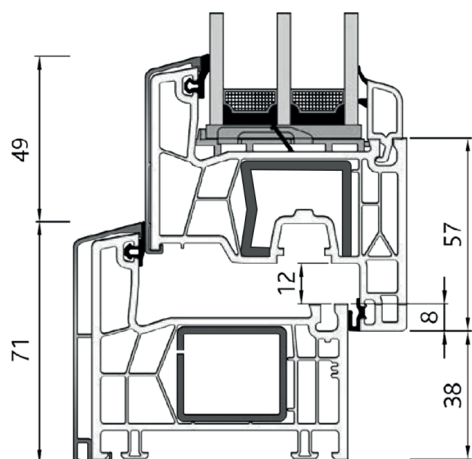

\* Heat transfer coefficient for the reference window ( $1230 \times 1480$ ,  $U_g=0.5 \text{ w}/\text{m}^2\text{K}$  with warm Chromatech Ultra spacer)







# Kömmerling 76 MD

## window system

A modern and best-in-class PVC window and door system

What characterizes the Kömmerling 76 MD system is, above all, the highest quality, measurable savings on energy costs, optimal protection against noise, reliable protection against burglary and various possibilities of shaping the external surface. The innovative design of the Kömmerling 76 MD system allows for the installation of modern triple glazing units with a thickness of up to 48 mm and various functional panes in the window.

The advantage of Kömmerling 76 MD is also high savings on energy costs - a 76 mm system with a rebate gasket with the highest thermal insulation parameters -  $U_w$  value for the reference window up to  $0.73 \text{ W}/(\text{m}^2\text{K})^*.$

Thanks to intelligent fastening techniques, professional assembly is carried out quickly, efficiently and without much effort, and thanks to the almost unlimited palette of veneer colors, the windows will perfectly fit into any building.

Windows in the Kömmerling 76 MD system are a choice without compromise. They are characterized by all the parameters of a modern window, both from the point of view of the shape of the geometry, through functionality, statics and coefficient of thermal and acoustic insulation, to environmental protection. It is possible to use AluClip aluminum overlays.

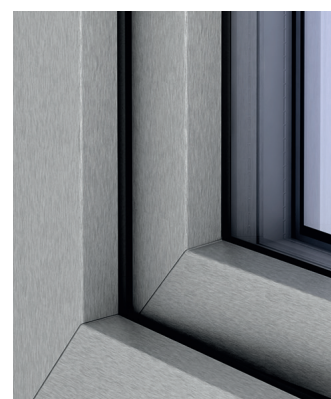
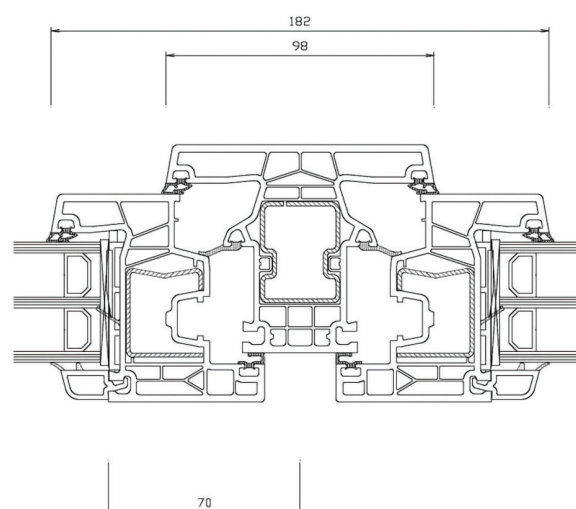
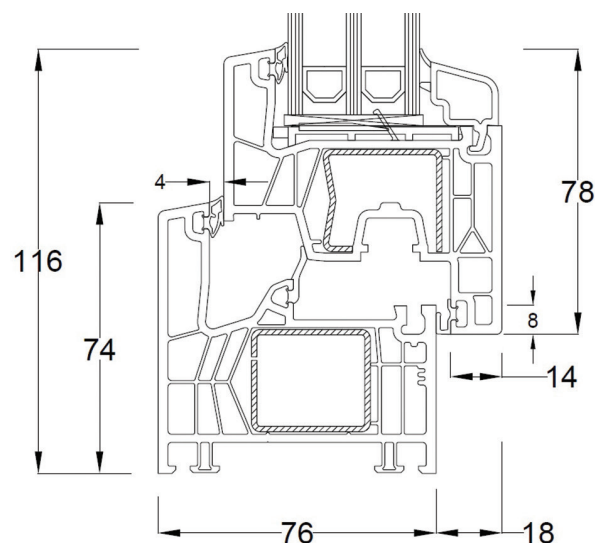

Colors and wooden structure

Universal smooth or embossed colors

Metallic color

white color

\* Heat transfer coefficient for the reference window ( $1230 \times 1480$ ,  $U_g=0.6 \text{ W}/\text{m}^2\text{K}$  with warm Chromatech Ultra spacer)





Heat transfer coefficient  $U_w=0.73 \text{ w}/(\text{m}^2\text{K})^*$



Acoustic insulation up to 47 dB



wind load resistance up to C5/B5  
Rainwater tightness up to 9A  
Air permeability up to class 4



Veneer in wood structure, universal or metallic colors



Anti-burglary protection



The systems are subject to various controls, they have the CE mark and declarations and certificates for all variants

## Kömmerling 76 MD aluminum cladding

### Kömmerling 76 MD AluClip

- Higher thermal insulation compared to aluminum windows
- $U_f$  value =  $1.2 \text{ W}/(\text{m}^2\text{K})$
- From the outside it looks like aluminum, inside natural warm white PVC
- Design depth 81.5 mm
- Almost unlimited color palette of aluminum elements
- $U_w = 0,80 \text{ W}/(\text{m}^2\text{K})^*$

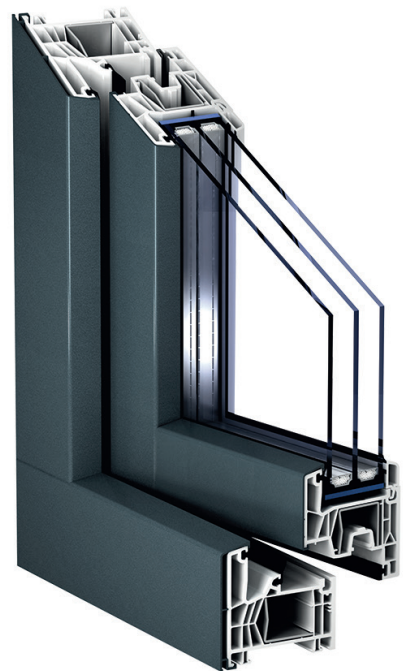
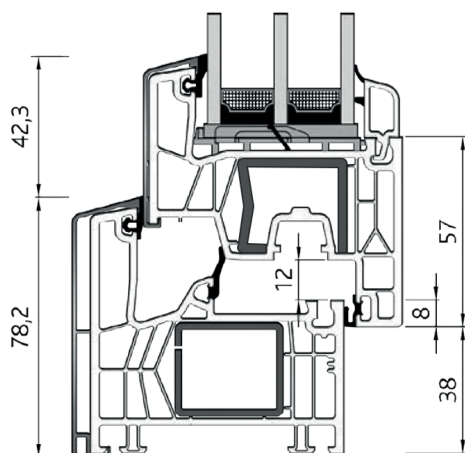

\* Heat transfer coefficient for the reference window (1230 x 1480,  $U_g=0.5 \text{ w}/\text{m}^2\text{K}$  with warm Chromatech Ultra spacer)

## Kömmerling 76 MD AluClip Zero

- $U_f$  value from 1,2 W/(m<sup>2</sup>K) for standard solutions up to 0,8 W/(m<sup>2</sup>K)
- Glazing range up to 50 mm
- System of profiles with a rebate seal with a construction depth of 81.5 mm, high strength thanks to the use of aluminum overlays
- Statistically durable aluminum overlays allow for not using steel in the sash, thus increasing the insulation

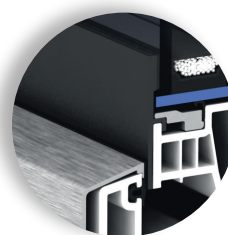
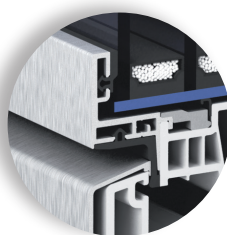
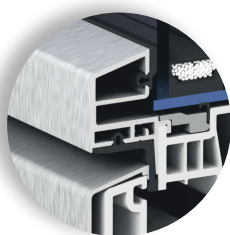

Aluminum variant A181



A variant with a matching frame and sash surface A180



All-glass variant A195

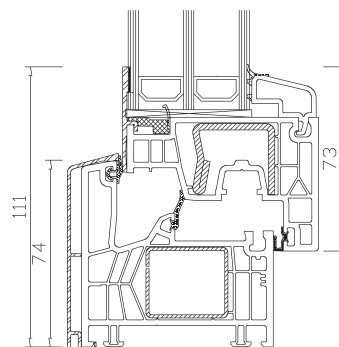
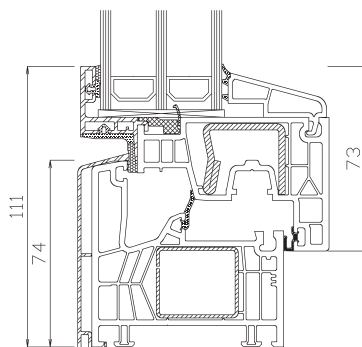
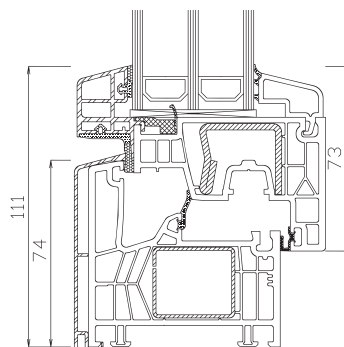







# Kömmerling 88

## window system

An innovative window and door system in the field of thermal insulation

Windows based on the Kömmerling 88 MD profiles are adapted to the prevailing trends in design and the changing consumers needs.

A wide range of construction variants will meet any design requirements. The construction of the window is based on a 7-chamber profile which, in a standard configuration with steel reinforcement, achieves thermal insulation parameters of a passive window ( $U_w = 0.73 \text{ W}/(\text{m}^2\text{K})^*$ ).

The 88 MD system offers a wide spectrum of colors and the possibility of installing special fittings that are invisible when the window is closed (hidden hinges). The intelligent design allows you to place a triple glazing unit with a maximum glazing range of up to 58 mm.

Kömmerling 88 MD, thanks to large glazing surfaces, ensures high solar energy recovery and at the same time guarantees exceptional protection against noise and burglary. The system offers high comfort of use and operational reliability, thanks to the use of state-of-the-art technology.

Kömmerling 88 MD is also available in a version with aluminum overlays - it is a combination of an elegant aluminum design in an almost unlimited range of colors and optimal thermal insulation parameters of plastic profiles. From the outside it looks like aluminum, inside - natural warm white PVC.

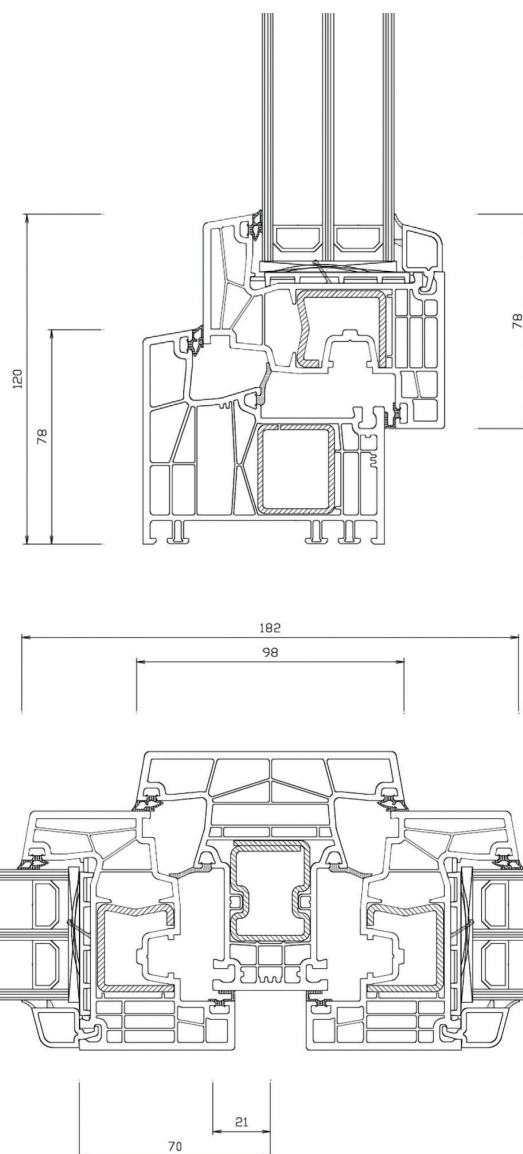

white color



Colors and wooden structure



Universal smooth or embossed colors

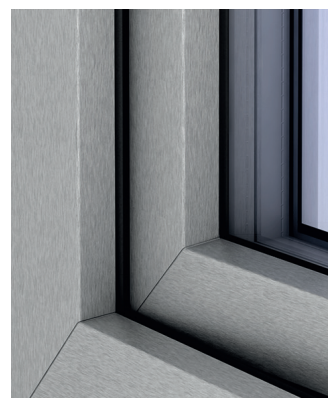

Metallic color

\* Heat transfer coefficient for the reference window (1230 x 1480,  $U_g = 0.5 \text{ W}/\text{m}^2\text{K}$  with warm Chromatech Ultra spacer)





Heat transfer coefficient  $U_w=0.73 \text{ w}/(\text{m}^2\text{K})^*$



Acoustic insulation up to 47 dB



wind load resistance up to C5/B5

Rainwater tightness up to 9A

Air permeability up to class 4



Veneer in wood structure, universal or metallic colors



Anti-burglary protection



The systems are subject to various controls, they have the CE mark and declarations and certificates for all variants

## Kömmerling 88 aluminum cladding

### Kömmerling 88 MD AluClip

- Higher thermal insulation compared to aluminum windows
- Central gasket system with a depth of 93.5mm
- $U_w = 0,8 \text{ W}/(\text{m}^2\text{K})^*$
- Possibility of glazing with a thickness of 24-58 mm
- Almost unlimited color palette of aluminum elements
- Maximum sash size: window - 150x150 cm, balcony door - 110x250 cm

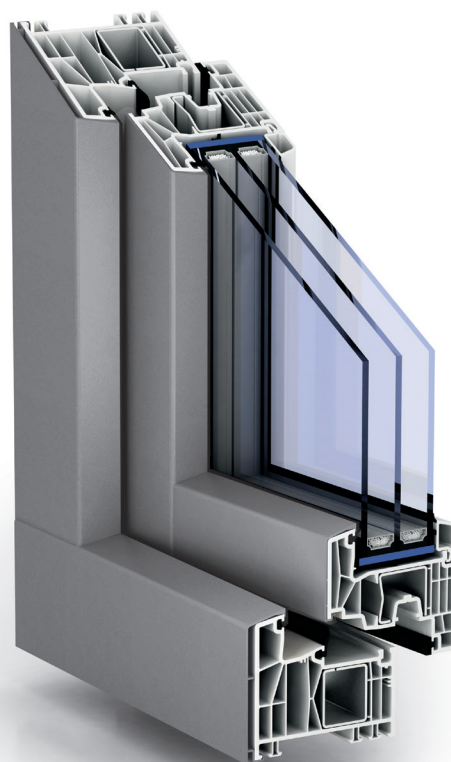
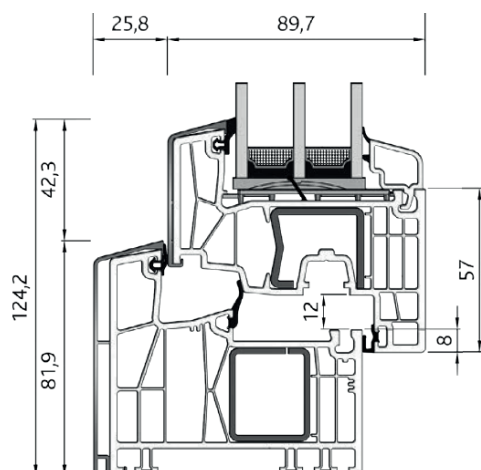

\* Heat transfer coefficient for the reference window (1230 x 1480,  $U_g=0.5 \text{ w}/\text{m}^2\text{K}$  with warm Chromatech Ultra spacer)



# Door SYSTEMS









# Kömmerling 76

## door system

Greater security and  
energy efficiency

The KÖMMERLING 76 door system meets all the requirements of high-quality door systems that open inwards and outwards. Highly insulating 5-chamber system provides optimal protection against cold and heat. Meets all safety requirements. It has steel reinforcement. The system is available in white, foiled in a wooden decor and in metallic colors. We also offer a system in the proCoverTec technology.

- Heat transfer coefficient  $U_d=0.82 \text{ W}/(\text{m}^2\text{K})^*$
- Design depth 76 mm
- 5 chamber system
- A threshold without barriers
- High anti-burglary protection
- Maximum leaf size: single-leaf entrance door 1200 x 2400 mm
- Double seal
- A wide range of colors
- Thanks to the glazing package up to 50 mm, it is possible to use any glass package or infill panel available on the market

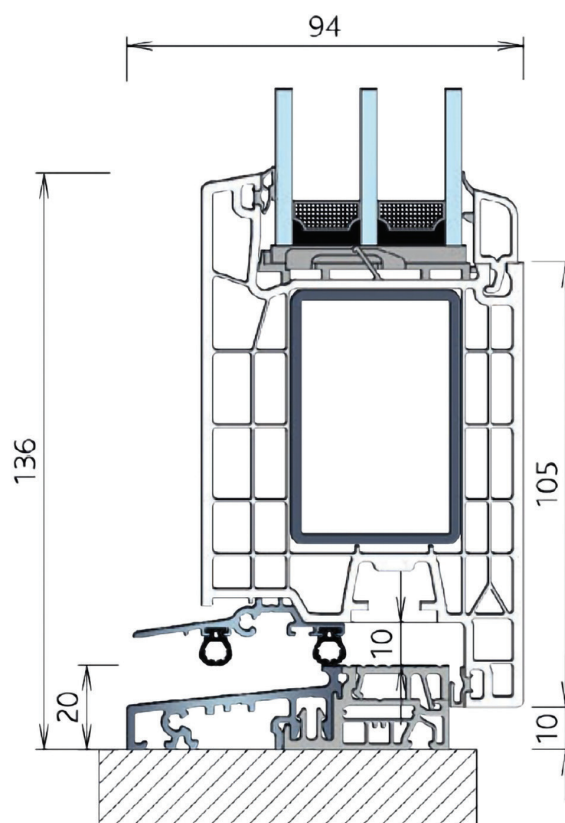

## Kömmerling 76 AD/MD

### aluminum cladding

#### Kömmerling 76 AluClip

- Highly insulating entrance door system with a depth of 76 mm, average  $U_f = 1.2 \text{ W}/(\text{m}^2\text{K})$
- 5-chamber construction with steel reinforcement
- High tightness - double sealing
- Threshold connector between the frame and the threshold
- High anti-burglary protection
- Maximum leaf dimensions: single-leaf entrance door 1200 x 2400 mm



\* For door size 1100x2200 mm with  $U_g = 0.5 \text{ W}/(\text{m}^2\text{K})$ ,  $\psi_s = 0.030$



## The door system in detail



1. The geometry of the profiles has been constructed based on the latest calculation methods with an optimally designed isothermal course. The result is high values of thermal insulation ( $U_d = 0.82 \text{ W/(m}^2\text{K)}^*$ ) and sound insulation, as well as very high stability of the door.
2. Possibility of using triple glazing, special functional panes or infill panels with a depth of up to 50 mm.
3. High tightness is achieved thanks to double sealing and a barrier-free threshold.
4. The entrance door system with an aluminum overlay is available both inward and outward opening.
5. A specially developed cross-section of steel reinforcements guarantees above-average door functionality and statics.
6. The threshold connector guarantees a precise fit and sealing of the entrance door threshold.

## Threshold systems

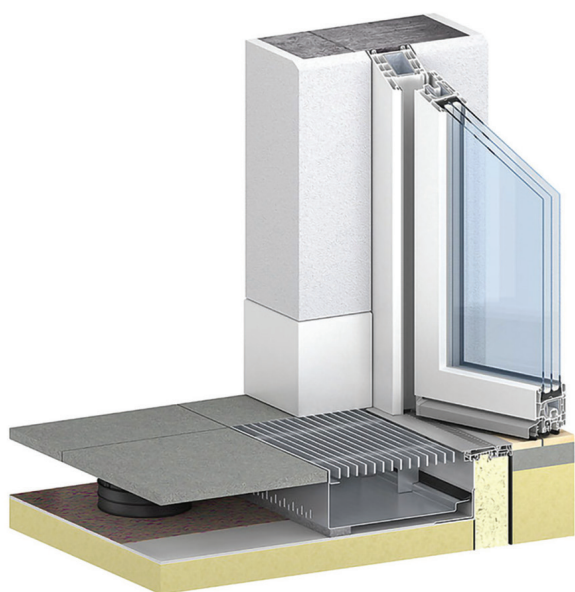

PremiPlan Plus 0 mm threshold

- Wind load resistance
- High rainwater tightness and air permeability
- Simple and professional assembly, thanks to a wide range of additional profiles

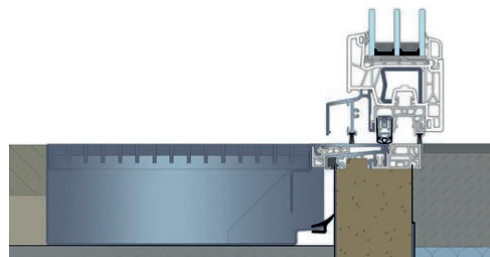

Exemplary combinations of entrance and terrace doors with the PremiPlan Plus system 76 MD threshold system

\* For door size 1100x2200 mm with  $U_g = 0.5 \text{ W/(m}^2\text{K)}$ ,  $\psi_i = 0.030$



# Kömmerling 88

## door system

### Greater security and energy efficiency

Kömmerling 88 MD door systems offer technological solutions that ensure safety, excellent sound insulation, protection against weather conditions and high living comfort. Large-size steel reinforcements create a solid, closed frame. The corners of the sashes are reinforced with corner connectors, which are connected to steel reinforcement.

- Heat transfer coefficient  $U_d = 0.82 \text{ W/(m}^2\text{K)}^*$
- Entrance doors to buildings are an ideal protection against rain and wind
- High thermal insulation parameters thanks to the thermally divided threshold
- Threshold connection variants meet every requirement
- Possibility of using practically any glazing units and door fillings
- Heat transfer coefficient  $U_f = 1.1 \text{ W/(m}^2\text{K)}$
- Single-leaf door 1200 x 2400 mm, entrance door 1000 x 2400 mm
- High anti-burglary protection
- Possibility of glazing 24 to 58 mm
- Sound insulation on request

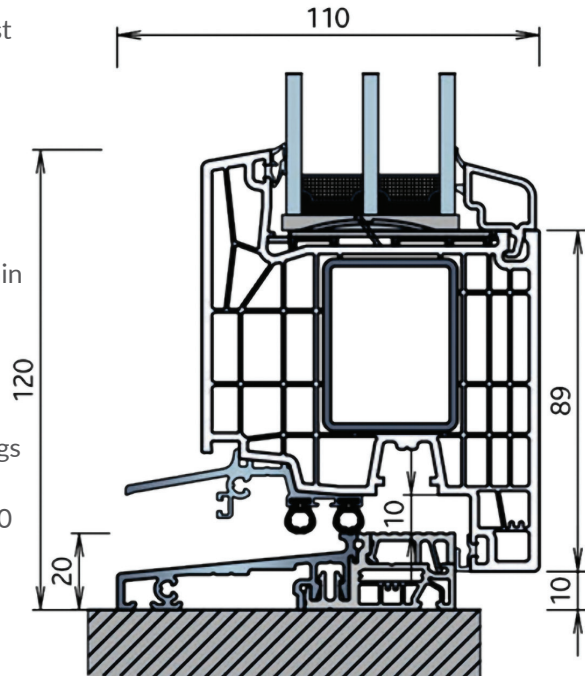

## Kömmerling 88 MD

### aluminum cladding

### Kömmerling 88 MD AluClip

- Highly insulating profile cross-section with a total depth of 88 mm -  $U_d = 1.2 \text{ W/(m}^2\text{K)}$
- Exceptional thermal protection compared to aluminum doors
- 6-chamber design
- High tightness thanks to double sealing
- A threshold without barriers
- Max leaf size:  
single-leaf door 1000 x 2200 mm  
entrance door 900 x 2200 mm

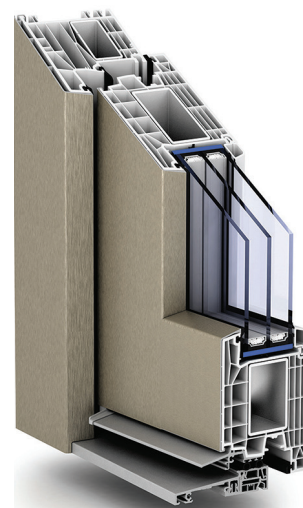

\* For door size 1100x2200 mm with  $U_g = 0.5 \text{ W/(m}^2\text{K)}$ ,  $\psi_s = 0.030$







## The door system in detail

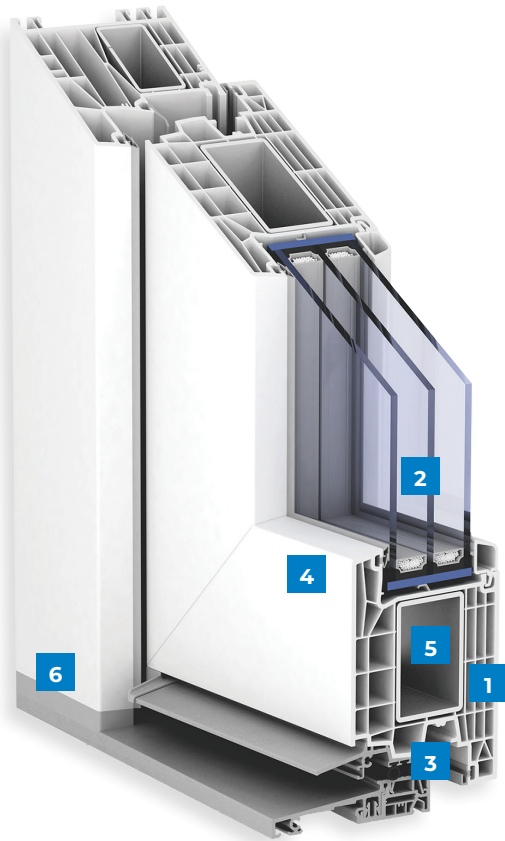

1. The geometry of the profiles was constructed based on the latest calculation methods with an optimally designed isothermal course. The result is high values of thermal insulation ( $U_d = 0.8^2 \text{ w/(m}^2\text{K)}^*$ ) and sound insulation, as well as very high stability of doors and windows.
2. Possibility of using triple glazing, special functional panes or infill panels with a depth of up to 56 mm.
3. High tightness is achieved thanks to double or triple sealing and a thermally divided entrance threshold.
4. The entrance door system with an aluminum cladding is available both inward and outward opening.
5. A specially developed cross-section of steel reinforcements guarantees above-average door functionality and statics.
6. The threshold connector guarantees a precise fit and sealing of the entrance door threshold.

## Threshold systems

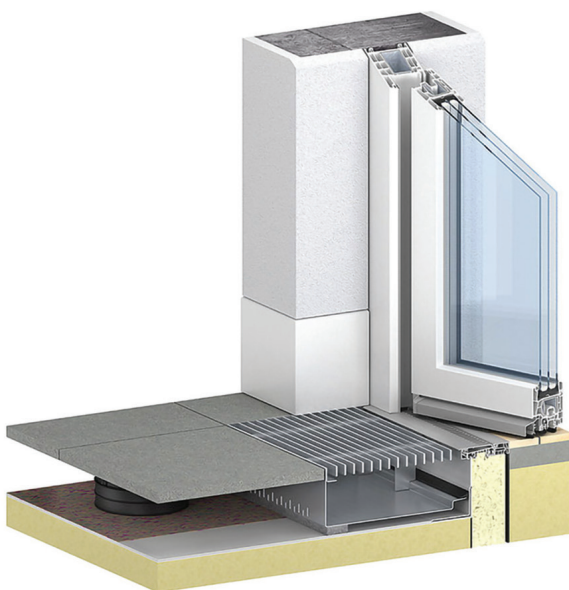

PremiPlan Plus 0 mm threshold

- wind load resistance
- High rainwater tightness and air permeability
- Simple and professional assembly, thanks to a wide range of additional profiles

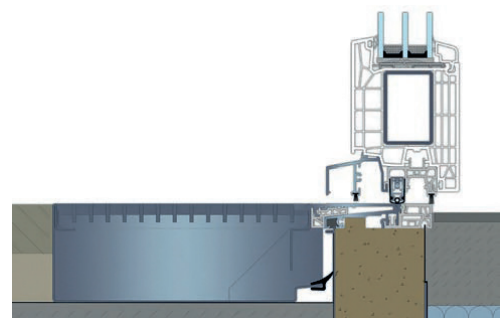

Exemplary combinations of entrance and terrace doors with the PremiPlan Plus system 88 MD threshold system

\* For door size 1100x2200 mm with  $U_g = 0.5 \text{ w/(m}^2\text{K)}$ ,  $\psi_i = 0.030$







# Sliding SYSTEMS









# PremiDoor 76

## sliding system

PremiDoor 76 allows for any arrangement of terraces, balconies and winter gardens

Premidoor 76 is an innovative system of lift and slide doors with a depth of 179 mm. It allows for any arrangement of terraces, balconies and winter gardens. A large area of glazing optically enlarges the room and optimally illuminates the interior. Thanks to our solutions, your house will open to the greenery outside the window, and the door will perfectly blend in with the atmosphere of the interior.

A modern barrier-free threshold as standard will provide you comfort and optimal thermal insulation - a five-chamber profile, construction width of the leaf 76 mm, frame 179 mm.

The PremiDoor 76 system with a heat transfer coefficient of  $U_f = 1.4 \text{ W/(m}^2\text{K)}$  is an excellent solution for both new construction and buildings undergoing renovation. By using PremiDoor 76 you will experience the feeling of complete freedom in your own home.

Premidoor 76 in the version with aluminum cladding ensure ease of care, resistance, elegance and cost-effectiveness. In addition, the overlays are available in a wide range of colors, refined by anodizing or powder coating.

Premidoor 76 also features a unique sealing system with a large-volume central gasket in the central lock, very slim lines with a leaf width of only 100 mm and a maximum element size of 6.50 m wide and 2.60 m high for white elements.

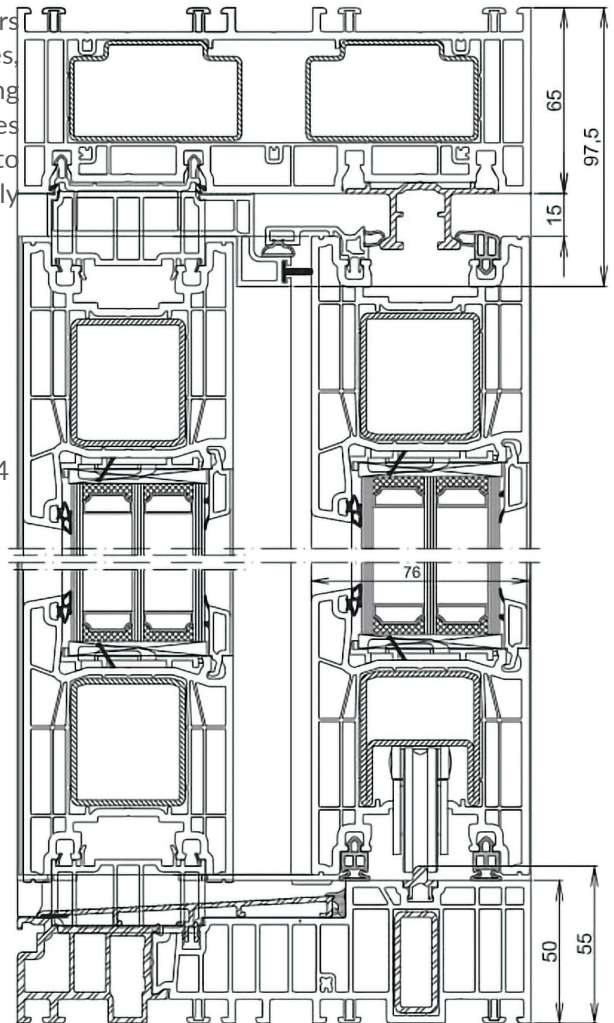

white color

Colors and wooden structure

Universal smooth or embossed colors

Metallic color





Heat transfer coefficient  $U_w$  from 0,9 W/(m<sup>2</sup>K)\*



Acoustic insulation up to 4<sup>2</sup> dB



wind load resistance up to C1/B2  
Rainwater tightness up to 6A-9A  
Air permeability up to class 4



Veneer in wood structure, universal or metallic colors



Anti-burglary protection



The systems are subject to various controls, they have the CE mark and declarations and certificates for all variants

## PremiDoor 76 aluminum cladding

### PremiDoor 76 AluClip

- An innovative system of lift and slide doors with a depth of 76 mm
- Maximum element length: 6 m
- Maximum element width: 2.40 m
- Coefficient  $U_f$  = 1,4 W/(m<sup>2</sup>K)
- $U_w$  from 0,74\* W/(m<sup>2</sup>K)
- Almost unlimited variety of colors

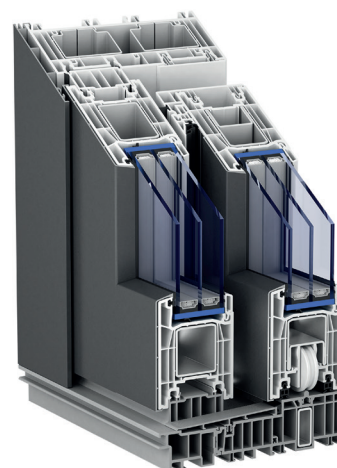

## PremiDoor 76 LUX narrow profile

### PremiDoor 76 LUX

- Very slender lines with the width of the leaf 100mm
- Innovative system, lift and slide doors with a depth of 76 mm
- Maximum element size 6.50 m wide and a height of 2.60 m
- Heat transfer coefficient  $U_f$  - average value = 1.3 W/(m<sup>2</sup>K)
- More solar gains



\* Heat transfer coefficient for reference sliding doors (4000x2400mm,  $U_g$ =0.5 W/m<sup>2</sup>K with Chromatech Ultra warm spacer bar)











# PremiSlide 76

## sliding system

PremiSlide 76 MD gives you the opportunity to create both small and large structures

The innovative locking mechanism is easy and intuitive to use, and the modern and slim design of the profiles ensures maximum natural light in the room. The intelligent design of the PremiSlide system allows you to place the warmest triple glazing unit with the  $U_g=0.5 \text{ W/(m}^2\text{K)}$  parameter. Thanks to large glazing surfaces, it provides high solar energy recovery, and at the same time guarantees exceptional protection against noise and burglary. The PremiSlide 76 MD system has a perfect thermal insulation coefficient. The standard  $U_f$  value is  $1.3 \text{ W/(m}^2\text{K)}$ . The sliding windows and terrace doors of the PremiSlide 76 MD system, thanks to their innovative design, not only do not limit the apartment, but on the contrary, they add and functionality to it. Solid, modern fittings ensure smooth and safe operation, and the sash control itself is intuitive and does not require excessive force.

The sliding function of the sash gives the possibility of slot ventilation, thus preventing it cooling down the entire room. PremiSlide 76 MD is also available with aluminum cladding – is a combination of elegant aluminum design in an almost unlimited palette of colors and optimal parameters of thermal insulation of plastic profiles. From the outside, it looks like aluminum, inside - natural warm white PVC.

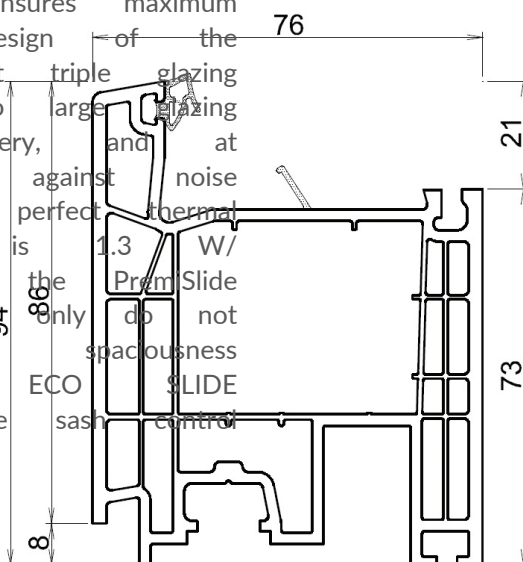

Sash

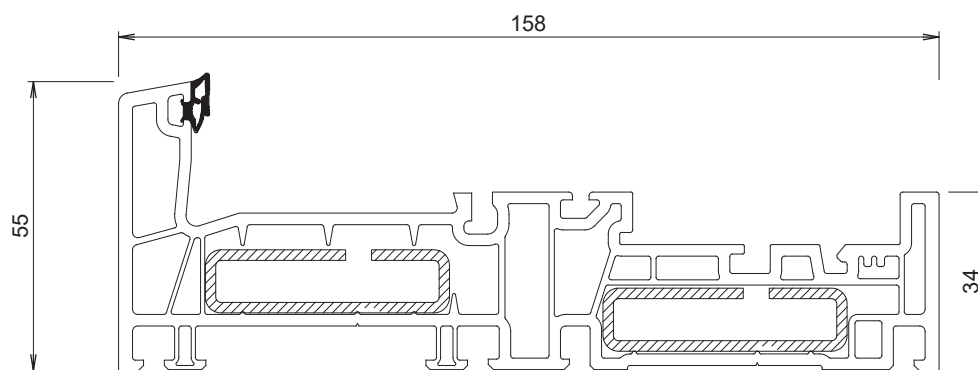

Frame



white color



Colors and wooden structure



Universal smooth or embossed colors



Metallic color





Heat transfer coefficient  $U_w=0.7 \text{ w}/(\text{m}^2\text{K})$



Acoustic insulation



wind load resistance up to C4/B5

Rainwater tightness up to 9A

Air permeability up to class 4



Veneer in wood structure, universal or metallic colors



Anti-burglary protection



The systems are subject to various controls, they have the CE mark and declarations and certificates for all variants



## PremiSlide 76 MD

### aluminum cladding

#### PremiSlide 76 AluClip

- PremiSlide 76 MD is a cutting-edge, innovative systemsiding with a construction depth of 158 mm
- Based on the KÖMMERLING 76 system
- Heat transfer coefficient  $U_f$  up to  $1.3 \text{ W}/(\text{m}^2\text{K})$  in standard
- Triple glazing with a maximum glass thickness of 50 mm
- Solid technology, "ECO SLIDE" hardware system
- Effective ventilation
- Easy and convenient operation

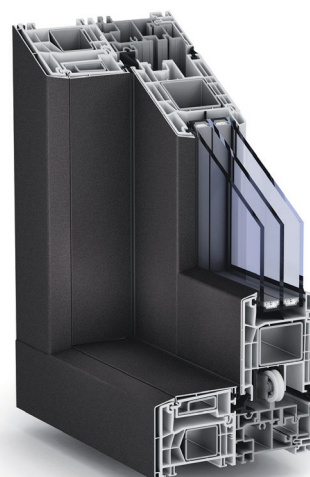











# | Color



The highest technology of varnishing PVC profiles offered by us enables the execution of joinery in original colors, and thus the possibility of matching the window to the arrangement of the interior and facade, as well as creating modern non-standard architectural designs. We offer almost unlimited freedom to choose the color of windows from the "Standard, Prestige, Premium" color palette by Profine, as well as from the entire range of the RAL palette.

The varnishing technology we provide uses the latest equipment achievements and improved materials, thus tightening the ecological regime. The process is accompanied by a multi-stage detailed quality control at various aspect of production. The result is a window with a full, homogeneous and durable paint coating, which remains smooth and homogeneous, resistant to climatic conditions, sunlight and abrasion.

Varnished windows OKNO-POL are covered by a 5-year warranty.







Color palette "Standard, Prestige, Premium" Profine





## Product overview

Elements mounted on the sash

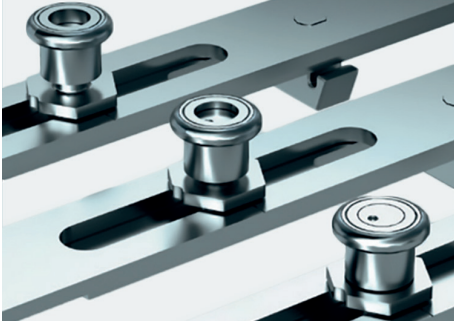

Frame elements



Hinge sides



Handles



Accessories



Automation



## Rotating knob

- allows smooth and trouble-free opening, tilting and closing of the window
- adjusts automatically to changing conditions, e.g. temperature
- always guarantees an optimally positioned and durable closing system
- enables smooth adjustment of the pressure



## Security packages from RC0 to RC<sup>2</sup>

Efficient system design with standard use of a rotating knob - better protection against potential burglary.

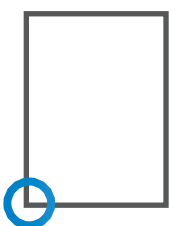

1 point  
basic protection

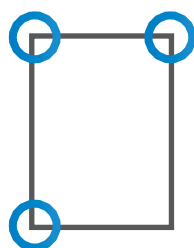

3 points  
basic protection

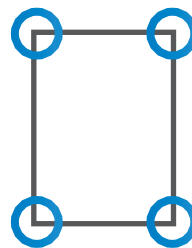

RC1

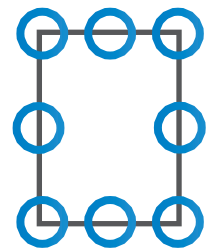

RC2



## Multifunctional corner

- allows for smooth and light opening and tilting and closing the window
- secures the windows in the open and tilt position
- guarantees optimal and durable operation of the locking system
- facilitates smooth insertion of the sash into the frame
- flexible use for all sizes windows

what distinguishes the multifunctional corner from other corners is primarily:

- 1 tilt hook
- 2 locking with a rotary knob
- 3 sash lift
- 4 blockade of incorrect operation of the sash

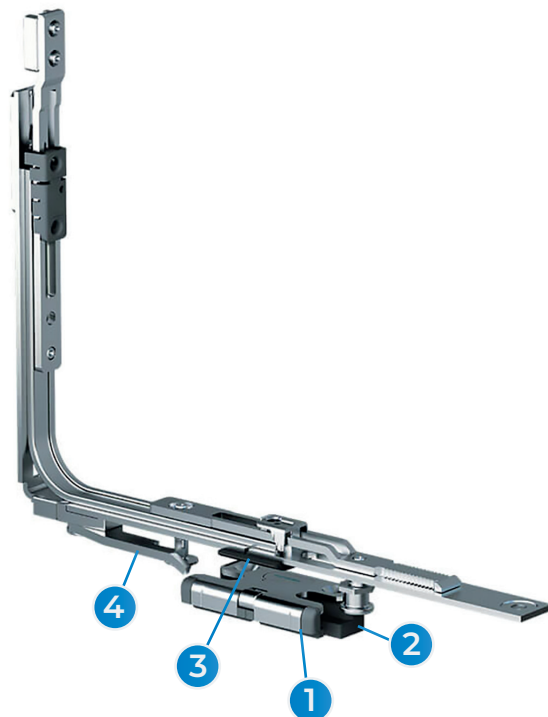

## Concealed hinge side TITAN axxent 24+

### Invisible mechanisms - subtle appearance



Axxent 24+ fittings are extremely easy to install, wear-resistant and safe as never before. Continuous sealing and integrated pressure adjustment guarantee excellent thermal insulation, while easy adjustment allows you to maintain comfortable operation of the sash for a long time. The bottom hinge is protected against dirt by a properly selected cover.

## Accessories

Balcony latch



protects the door against sudden opening or slamming

Sash brake



individual setting of the opening width: the sash is locked in the desired position

Additional stay

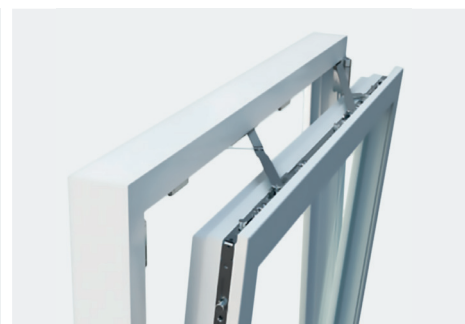

reduces the effort when closing the sash from the tilt position through the integrated cushioning



